

BOND1NE[®]
EPOXY ADHESIVES



ADHESIVE



BONDS TOGETHER FOREVER

HINDUSTHAN SPECIALITY CHEMICALS LIMITED (HSCL)

HSCL is a part of The Hindusthan Group having interests in manufacturing and marketing of epoxy and allied products. HSCL started operations in July' 2015 for manufacturing of epoxy and other allied products in Bharuch, Gujarat. It intends to provide complete solutions to customers with technologically advanced materials through innovation and its principles of sustainability. HSCL's products will find application in civil, construction, coatings, electrical & electronics, composites, laminations, adhesives, tooling and other niche end-use segments.

We are committed to serve quality products to our clients. Our quality lab is equipped with world class instruments which can help us to achieve excellence in both incoming raw materials and outgoing value added products. Our quality team is composed of highly qualified chemists who know the right basics and are competent to test the products for their right application. We value our team and train them for the new technologies that can help achieving results quickly and with great reliability.

HSCL believes in innovation and value added research. We have invested in valuable assets both trained technologists and highly sophisticated instruments. HSCL Research & Development facilities will take care of value-added application tests, our dedicated step in this direction will enable our customers to know the performance of their product in the exhaustive working environments. HSCL aims planned continual growth by its dedicated efforts towards research & development.

VISION



To become a globally recognised manufacturer of Epoxy Resins & Speciality Chemicals by delivering enhanced value for all our stake-holders through best-in-class technology, innovation & differentiated products & services.

MISSION



To invest in sustainable, innovative technologies and operational excellence to deliver growth in strategically targeted markets together with exceptional customer service.

Our state-of-the-art manufacturing unit
Jhagadia, Bharuch in Gujarat



Customer Focus

Our actions are driven by customer insights that help them to create value.



Innovation

We develop new products by relentlessly pursuing "Why & What If". We strive to closely understand customer needs & market insights to create competitive advantage.



Collaboration

Working together, both internally and externally, to create better solutions.



Transparency & Integrity

We demonstrate high degree of transparency and integrity by taking full responsibility of our actions. We are trustworthy in our transparent and ethical manner.



Excellence

We strive to achieve excellence in everything we do through shared knowledge, personal development, continuous improvement, safety and best-in-class execution.



BOND1ONE[®] SUPER STRENGTH

BondOne Super Strength is a multi purpose, thixotropic, two component, medium viscous epoxy adhesive system.



Applications

- Metal to metal and metal to glass bonding
- Plastic to plastic bonding
- Electronics, textile reed and handicrafts
- Automobiles | Construction | Engineering

Features - Benefits

- Superior bond strength
- Resistance to mild acids and alkalis
- Good chemical resistance

Mixing ratio by weight (R:H)	Pot life at 25°C 100 gm mass (Min)	Bond Strength (kg/cm ²) at 25°C after 24 hrs.
100:80	70 - 90	Min 120

Coverage (sq. ft.)

Will vary based on surface and application

SKUs | Packaging Units

450 gm	900 gm	1.8 kg
9 kg		90 kg

Mix Viscosity (mPas) at 25°C

30,000 - 45,000

Drying time (min) at 35°C

Surface dry	Touch dry	Hard dry
75 - 85	140 - 150	220 - 240

Shelf life

24 Months

Method of application



Make sure that application surface | substrate is clean, dry and free from oil, dust, grease and other contaminants.

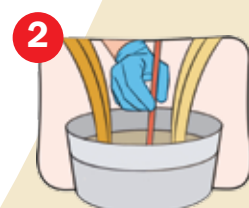

Mix resin and hardener in 100:80 ratio by weight on clean dry and even surface. Mix thoroughly till uniform homogeneous mixture is formed.



Apply on surface to be bonded.



Apply contact pressure using suitable fixture. Allow to dry for 24 hours to get full strength.



Optimum layer of 0.1 to 0.2 mm gives optimum strength.



BOND1ONE[®] SUPER SPEED

BondOne Super Speed is a multi purpose, two component, epoxy adhesive system.



Applications

- Metal to metal and metal to glass bonding
- Plastic to plastic bonding
- Electronics, textile reed and handicrafts
- Automobiles | Construction | Engineering

Features - Benefits

- Superior bond strength
- Very low shrinkage
- Good chemical resistance

Mixing ratio by weight (R:H)	Pot life at 25°C 100 gm mass (Min)	Bond Strength (kg/cm ²) at 25°C after 24 hrs.
100:80	60 - 80	Min 100

Coverage (sq. ft.)

Will vary based on surface and application

SKUs | Packaging Units

450 gm	900 gm	1.8 kg
9 kg		90 kg

Mix Viscosity (mPas) at 25°C

30,000 - 45,000

Drying time (min) at 35°C

Surface dry	Touch dry	Hard dry
50 - 60	120 - 130	200 - 220

Shelf life

24 Months

Method of application



Make sure that application surface | substrate is clean, dry and free from oil, dust, grease and other contaminants.



Mix resin and hardener in 100:80 ratio by weight on clean dry and even surface. Mix thoroughly till uniform homogeneous mixture is formed.



Apply on surface to be bonded.



Apply contact pressure using suitable fixture. Allow to dry for 24 hours to get full strength.

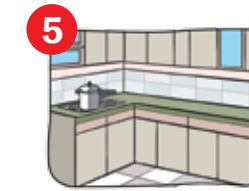

Optimum layer of 0.1 to 0.2 mm gives optimum strength



BONDONE[®] POWERTITE

BondOne Powertite is a two component, modified epoxy adhesive system.

It gives excellent bond strength with most of substrates like glass, metals, reactive plastics, wood, textile and natural stone.



Applications

- Artificial jewellery & Jewel stone fixing
- Electrical | Automobile | Engineering components
- Marble | Granite fixing | Construction
- Sports goods

Features - Benefits

- High bond strength and mechanical strength
- Thermally stable
- Water and chemical resistant

Method of application

Mixing ratio by weight (R:H)	Pot life at 25°C 10 gm mass (Min)	Bond Strength (kg/cm ²) at 25°C after 24 hrs.
100:80	65 - 85	Min 95

Coverage (sq. ft.)

70 - 75 in 1.8 kg for stone fixing

SKUs | Packaging Units

450 gm	900 gm
1.8 kg	9 kg
	90 kg

Mix Viscosity (mPas) at 25°C

28,000 - 39,000

Drying time (min) at 25°C

Surface dry	Touch dry	Hard dry
105 - 135	305 - 325	505 - 535

Shelf life

24 Months



Make sure that application surface | substrate is clean, dry and free from oil, dust, grease and other contaminants.



Mix resin and hardener in 100:80 ratio by weight on clean dry and even surface. Mix thoroughly till uniform homogeneous mixture is formed.



With the help of spatula apply this mixture on surface to be bonded.

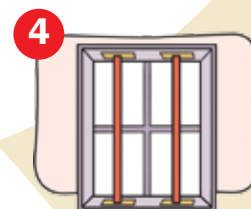

After application place substrate in stable position for 8 - 9 hours with suitable support.

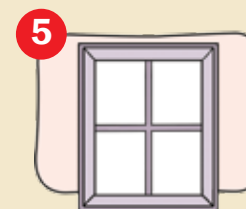

Allow to dry for 24 hours to get full strength.



BONDONE[®] CLEAR & SPEED

BondOne Clear & Speed is two component modified epoxy adhesive system.



Applications

- Glass to glass bonding
- Metal to metal bonding
- Metal to non metal bonding
- Electronic component bonding

Features - Benefits

- Rapid curing
- Superior bond strength

Mixing ratio by weight (R:H)	Pot life at 25°C 10 gm mass (Min)	Bond Strength (kg/cm ²) at 25°C after 24 hrs.
100:100	3 - 7 (10 gm mass)	Min 80

Coverage (sq. ft.)

NA

SKUs | Packaging Units

36 gm	180 gm	270 gm
1 kg	2 kg	60 kg

Mix Viscosity (mPas) at 25°C

NA

Drying time (min) at 25°C

Surface dry	Touch dry	Hard dry
5 - 7	15 - 25	90 - 100

Shelf life

Resin: 24 Months

Hardener: 12 Months

Method of application



Make sure that application surface | substrate is clean, dry and free from oil, dust, grease and other contaminants.



Mix resin and hardener in 100:100 ratio by weight (not more than 10gm at a time) on clean dry and even surface. Mix thoroughly till uniform homogeneous mixture is formed.

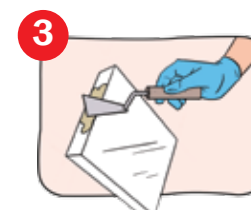

Apply immediately on surface to be bonded, apply contact pressure using suitable fixture.



Allow to dry for 24 hours to get full strength.

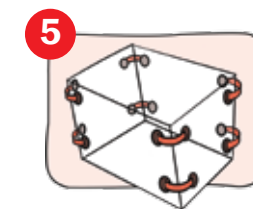

Optimum layer of 0.1 to 0.2 mm gives optimum strength.

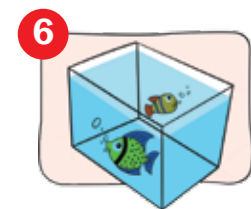

Allow to dry for 24 hours to get the full strength.



BONDONE[®] SUPER QUICK EPOXY

BondOne Super Quick Epoxy is a solvent free, two component, rapid curing adhesive system.



Applications

- Bonding metal and ceramics
- Bonding glass and rigid plastics
- Areas where high temperature is required

Features - Benefits

- Temperature resistance to 100°C
- No shrinkage
- Low volatile loss

Mixing ratio by weight (R:H)	Pot life at 25°C 100 gm mass (Min)	Bond Strength (kg/cm ²) at 25°C after 24 hrs.
100:75	10 - 15	Min 100

Coverage | DFT (sq. ft. | microns)

NA

SKUs | Packaging Units

875 gm	1.75 kg	8.75 kg
--------	---------	---------

Mix Viscosity (mPas) at 25°C

NA

Drying time (min) at 25°C

Surface dry	Touch dry	Hard dry
15-20	40-45	120

Shelf life

12 Months

Method of application



Make sure that application surface | substrate is clean, dry and free from oil, dust, grease and other contaminants.



Mix resin and hardener in 100:75 ratio by weight on clean dry and even surface. Mix thoroughly till uniform homogeneous mixture is formed.



Apply on surface to be bonded.



Apply contact pressure using suitable fixture. Allow to dry for 24 hours to get full strength.



Optimum layer of 0.1 to 0.2 mm gives optimum strength.



BONDONE[®] WOODFIL

BondOne Woodfil is a two component, thixotropic epoxy adhesive system.



Applications

- Bonding and gap filling in wooden furniture
- Bonding in wooden floor
- Bonding in wooden handicrafts
- Bonding in wooden boats and houses

Features - Benefits

- High bond strength
- Water and chemical resistance
- Electrical insulation

Mixing ratio by weight (R:H)	Pot life at 25°C 100 gm mass (Min)	Bond Strength (kg/cm ²) at 25°C after 24 hrs.
100:80	60 - 80	Min 110

Coverage (sq. ft.)

Depends on substrate and depth of filling

SKUs | Packaging Units

450 gm	1.8 kg
--------	--------

Mix Viscosity (mPas) at 25°C

15,000 - 25,000

Drying time (min) at 25°C

Surface dry	Touch dry	Hard dry
65 - 85	165 - 185	265 - 285

Shelf life

12 Months

Method of application



Make sure that wooden application surface | substrate is clean, dry and free from oil, dust, grease and other contaminants.



Mix resin and hardener in 100:80 ratio by weight on clean dry and even surface. Mix thoroughly till uniform homogeneous mixture is formed.

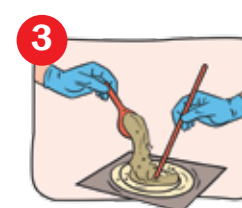

Add saw dust as per requirement to get desired thickness of the mixture.



Apply on surface to be bonded or fill in cracks of wood.



Allow to cure for 4 - 5 hours for surface grinding at normal ambient conditions.



Allow to dry for 24 hours to get the full strength.



BOND1ONE[®] WOODFIX

BondOne Woodfix is a two component, thixotropic epoxy adhesive system.



Applications

- Bonding and gap filling in wooden furniture
- Bonding in wooden floor
- Bonding in wooden handicrafts
- Bonding in wooden boats and houses

Features - Benefits

- High bond strength
- Water and chemical resistance
- Electrical insulation

Mixing ratio by weight (R:H)	Pot life at 25°C 100 gm mass (Min)	Bond Strength (kg/cm ²) at 25°C after 24 hrs.
100:80	35 - 55	Min 110

Coverage (sq. ft.)

Depends on substrate and depth of filling

SKUs | Packaging Units

450 gm	1.8 kg
--------	--------

Mix Viscosity (mPas) at 25°C

15,000 - 25,000

Drying time (min) at 25°C

Surface dry	Touch dry	Hard dry
40 - 60	70 - 90	100 - 120

Shelf life

12 Months

Method of application



Make sure that wooden application surface | substrate is clean, dry and free from oil, dust, grease and other contaminants.



Mix resin and hardener in 100:80 ratio by weight on clean dry and even surface. Mix thoroughly till uniform homogeneous mixture is formed.

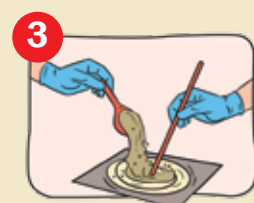

Add saw dust as per requirement to get desired thickness of the mixture.



Apply on surface to be bonded or fill in cracks of wood.



Allow to cure for 3 - 4 hours for surface grinding at normal ambient conditions.



Allow to dry for 24 hours to get the full strength.



BOND1ONE[®] THICKSO

BondOne Thickso is a two component, filled epoxy adhesive system.

It gives excellent bond strength with most of substrates like stone, textiles, wood, glass and metal.



Applications

- Wooden furniture and floor
- Electric bulbs and handicrafts
- Potting system for small electronics
- Textile reeds
- Automobile, construction, engineering

Features - Benefits

- High cohesive strength
- Negligible shrinkage
- Excellent dimensional stability

Mixing ratio by weight (R:H)	Pot life at 25°C 100 gm mass (Min)	Bond Strength (kg/cm ²) at 25°C after 24 hrs.
100:100	35 - 55 (150 gm mass)	Min 100

Coverage | DFT (sq. ft. | microns)

Depends on substrate and depth of filling

SKUs | Packaging Units

2 kg

Mix Viscosity (mPas) at 25°C

15,000 - 25,000

Drying time (min) at 35°C

Surface dry	Touch dry	Hard dry
40 - 60	80 - 100	140 - 160

Shelf life

12 Months

Method of application



Make sure that application surface | substrate is clean, dry and free from oil, dust, grease and other contaminants.



Mix resin and hardener in 100:100 ratio by weight on clean dry and even surface. Mix thoroughly till uniform homogeneous mixture is formed.

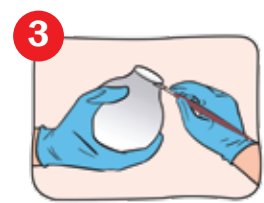

Apply on surface to be bonded.

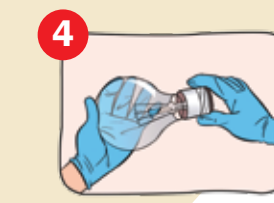

Fix the bottom.

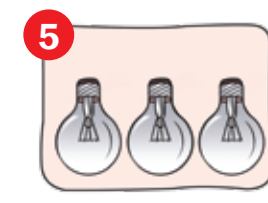

Allow to dry for 24 hours to get full strength.



BONDONE[®] THICKSO S

BondOne Thickso S is a two component, filled epoxy adhesive system.

It gives excellent bond strength with most of substrates like stone, textiles, wood, glass and metal.



Applications

- Wooden furniture and floor
- Electric bulbs and handicrafts
- Potting system for small electronics
- Textile reeds
- Automobile, construction, engineering

Features - Benefits

- High cohesive strength
- Negligible shrinkage
- Excellent dimensional stability

Mixing ratio by weight (R:H)	Pot life at 25°C 100 gm mass (Min)	Bond Strength (kg/cm ²) at 25°C after 24 hrs.
100:80	60 - 70 (150 gm mass)	Min 100

Coverage | DFT (sq. ft. | microns)

Depends on substrate and depth of filling

SKUs | Packaging Units

1.8 kg

Mix Viscosity (mPas) at 25°C

15,000 - 25,000

Drying time (min) at 35°C

Surface dry	Touch dry	Hard dry
70-80	120-140	180-200

Shelf life

12 Months

Method of application



Make sure that application surface | substrate is clean, dry and free from oil, dust, grease and other contaminants.

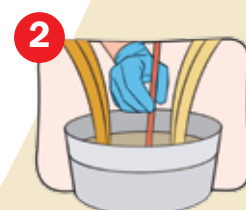

Mix resin and hardener in 100:80 ratio by weight on clean dry and even surface. Mix thoroughly till uniform homogeneous mixture is formed.



Apply on surface to be bonded - textile reed.

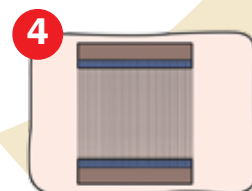

Allow to dry for 24 hours to get full strength.



BONDONE[®] CLEARTITE

BondOne Cleartite is a two component, modified, high viscosity epoxy adhesive system.



Applications

- Lamination in jewellery and jewel stone fixing
- Zari fixing in textiles, textile reeds
- Decorative arts, paint rollers

Features - Benefits

- Long pot life
- Clear transparent film
- Water & Chemical resistant

Mixing ratio by weight (R:H)	Pot life at 25°C 100 gm mass (Min)	Bond Strength (kg/cm ²) at 25°C after 24 hrs.
100:100	65 - 80	Min 120

Coverage (sq. ft.)

Depends on substrate & depth of filling

SKUs | Packaging Units

2 kg

Mix Viscosity (mPas) at 25°C

35,000 - 40,000

Drying time (min) at 25°C

Surface dry	Touch dry	Hard dry
80 - 100	240 - 260	490 - 510

Shelf life

12 Months

Method of application



Make sure that application surface | substrate is clean, dry and free from oil, dust, grease and other contaminants.



Mix resin and hardener in 100:100 ratio by weight and mix thoroughly.



Apply properly on the glass substrate to be bonded, give induction time of 2-5 min before application on substrate. Allow to dry for 8 - 9 hours to get proper finish.



It will take longer to dry and will give poor finish at low temperature below 15°C, in that case warm resin and hardener prior to application upto 40°C.

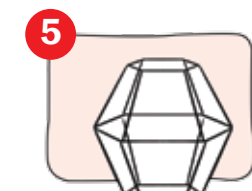

Full strength will be achieved in 24 hours.



BONDONE[®] VISCIOUS & CLEAR

BondOne Viscous & Clear is a ambient curing, very high viscous epoxy adhesive system.



Applications

- Shell bonding and bangle making
- Artificial jewellery & Jewel stone fixing
- Handicrafts

Features - Benefits

- High strength
- Clear film
- Thermostable
- Water and Chemical resistance

Mixing ratio by weight (R:H)	Pot life at 25°C 100 gm mass (Min)	Bond Strength (kg/cm ²) at 25°C after 24 hrs.
100:90	55 - 65	Min 70

Coverage (sq. ft.)

NA

SKUs | Packaging Units

475 gm	1.9 kg	9.5 kg
--------	--------	--------

Mix Viscosity (mPas) at 25°C

75,000 - 100,000

Drying time (min) at 35°C

Surface dry	Touch dry	Hard dry
48 - 60	75 - 85	165 - 185

Shelf life

24 Months

Method of application



Mix resin and hardener thoroughly in 100:90 ratio.



Add white pigment to match color of Shankh Bangle.

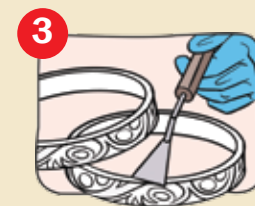

Use mixture for bonding of Shankh Bangle.



Allow to cure for 24 hours to get full handling strength.



Make design as per requirement with suitable tool.



Final finished product using BondOne Viscous and Clear.



BONDONE[®] GAHANA

BondOne Gahana is two component modified, viscous, epoxy adhesive system



Applications

- Bangle industries
- Artificial jewellery and jewel stone fixing
- Natural stone souvenirs

Features - Benefits

- High bond strength
- High filler loading
- Long pot life

Mixing ratio by weight (R:H)	Pot life at 25°C 100 gm mass (Min)	Bond Strength (kg/cm ²) at 25°C after 24 hrs.
100:80	140 - 165	Min 100

Coverage | DFT (sq. ft. | microns)

Will vary based on thickness

SKUs | Packaging Units

1.8 kg	9 kg
--------	------

Mix Viscosity (mPas) at 25°C

22,000 - 32,000

Drying time (min) at 25°C

Surface dry	Touch dry	Hard dry
150 - 180	480 - 540	900 - 1080

Shelf life

Resin: 24 Months

Hardener: 12 Months

Method of application



1. Make sure that application surface | substrate is clean, dry and free from oil, dust, grease and other contaminants.



Mix resin and hardener in 100:80 ratio by weight on clean dry and even surface. Mix thoroughly till uniform homogeneous mixture is formed.



Apply on surface to be bonded, apply contact pressure using suitable fixture.



Apply on surface of bangle for fixing of stones and design elements.

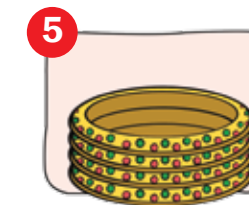

Allow to dry for 24 hours to get full strength.



BONDONE[®] GAHANA S

BondOne Gahana S is two component modified, viscous, epoxy adhesive system.



Applications

- Bangle industries
- Artificial jewellery and jewel stone fixing
- Natural stone souvenirs

Features - Benefits

- High bond strength
- Long pot life
- Thermally stable

Mixing ratio by weight (R:H)	Pot life at 25°C 100 gm mass (Min)	Bond Strength (kg/cm²) at 25°C after 24 hrs.
100:80	220 - 260	Min 100

Coverage | DFT (sq. ft. | microns)

Will vary based on thickness

SKUs | Packaging Units

1.8 kg	9 kg
--------	------

Mix Viscosity (mPas) at 25°C

22,000 - 32,000

Drying time (min) at 25°C

Surface dry	Touch dry	Hard dry
180 - 210	510 - 570	900 - 1080

Shelf life

Resin: 24 Months
Hardener: 12 Months

Method of application



Make sure that application surface | substrate is clean, dry and free from oil, dust, grease and other contaminants.



Mix desired quantity of powder in both resin and hardener separately to get required consistency.



Mix both resin and hardener dough in 100:100 ratio.



Apply on top of metal base for the fixing of various design elements.



Allow to dry for 24 hours to get full strength and hardness.



BONDONE[®] EASYTITE

BondOne Easytite is two component modified, viscous epoxy adhesive system.

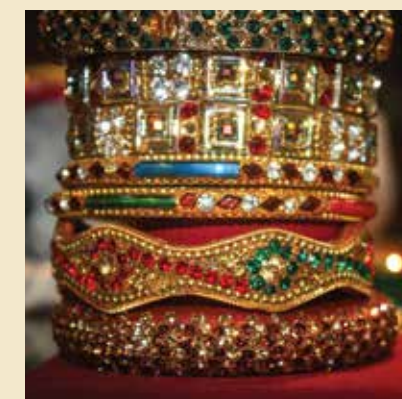

Applications

- Souvenirs and handicrafts
- Artificial jewellery
- Bangles and ceramics

Features - Benefits

- Thermostable
- Water and chemical resistant
- Electrical insulation

Mixing ratio by weight (R:H)	Pot life at 25°C 100 gm mass (Min)	Bond Strength (kg/cm²) at 25°C after 24 hrs.
100:80	70-85	Min 80

Coverage | DFT (sq. ft. | microns)

NA

SKUs | Packaging Units

1.8 kg	9 kg	54 kg
--------	------	-------

Mix Viscosity (mPas) at 25°C

26,000 - 32,000

Drying time (min) at 36°C

Surface dry	Touch dry	Hard dry
125 - 145	305 - 325	525 - 550

Shelf life

12 Months

Method of application



Make sure that application surface | substrate is clean, dry and free from oil, dust, grease and other contaminants.



Mix resin and hardener in 100:80 ratio by weight on clean dry and even surface. Mix thoroughly till uniform homogeneous mixture is formed.



Apply well on the surface of Bangle Kada by adding desired color pigments.

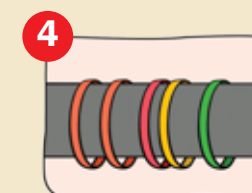

Allow to dry for 24 hours to get full curing and hardness.

BOND1NE®
VIBETITE

Notes



BondOne Vibetite is a two component, modified epoxy adhesive system.



Applications

- Jari and foil transfer in bangle application
- Ceramics
- Souvenirs and handicrafts
- Artificial jewellery

Features - Benefits

- Thermostable
- Water and chemical resistant
- Electrical insulation

Mixing ratio by weight (R:H)	Pot life at 25°C 100 gm mass (Min)	Bond Strength (kg/cm²) at 25°C after 24 hrs.
100:80	75 - 85	Min 95

Coverage | DFT (sq. ft. | microns)

NA

SKUs | Packaging Units

1.8 kg	9 kg	54 kg
--------	------	-------

Mix Viscosity (mPas) at 25°C

28,000 - 30,000

Drying time (min) at 25°C

Surface dry	Touch dry	Hard dry
90 - 110	320 - 340	390 - 410

Shelf life

12 Months

Method of application

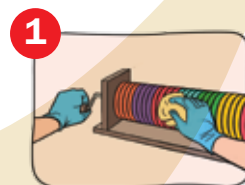

Make sure that application surface | substrate is clean, dry and free from oil, dust, grease and other contaminants.



Mix resin and hardener in 100:80 ratio by weight on clean dry and even surface. Mix thoroughly till uniform homogeneous mixture is formed.



Add required quantities of thinner and jari for the application.



Apply on surface of
single glass bangle.

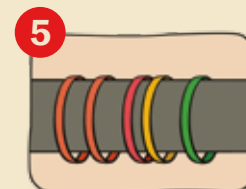

Allow to dry for 24 hours
to get full hardness.



Contributing to the development of the Indian economy for more than 6 decades, we are a multi – discipline, multi – location, well diversified industrial conglomerate involved in core sector areas like Engineering, Electricals, Chemicals, Agro Based products, Renewable Energy & Education. We are powered by an able and dynamic team of committed professionals and a vast pool of skilled manpower. Equipped with state-of- art technology, we have industrial units and offices spread across various locations of the country & our team strength has been growing over the years. Continuously seeking initiatives for diversification, expansion and optimization translating into new products and innovations; we have catapulted ourselves into the frontiers of technology in each area of our activities through strategic alliances and mutual partnerships with global leaders and thrusting a major focus on research development and human resources. With such a long and strong history behind us, we have a remarkable foothold in government sectors and overseas market.



Head Office

Kanchenjunga, 7th Floor, 18, Barakhamba Road,
New Delhi - 110001.

T: +91 11 23310001/02/03/04/05

Marketing & Sales Office

65, Free Press House, Free Press Journal Road,
Nariman Point, Mumbai - 400021.

T: +91 22 61510960

Factory Address

Hindusthan Speciality Chemicals Ltd.
Plot No. 830, GIDC, Jhagadia Industrial Estate, Jhagadia,
Bharuch, Gujarat - 393110.

Regional Presence: **Delhi | Mumbai | Kolkata | Chennai**

For more information, please email us at support.hscl@hindusthan.com

or call at **9117 020202**

www.hindusthanspeciality.com

